

Timelock Warranty and Guarantee

We are proud to offer the finest warranty/guarantee in the industry.

1. The guarantee program provides to the OEM a reimbursement to be applied against any opening/repair cost incurred when it has been determined that the mechanical timelock is the reason for the failure. This excludes errors in the installation, service, or operation of the mechanical timelock. Such reimbursements are subject to the following conditions:
 - a. Any work performed on the container must be accomplished by a "qualified" timelock technician. A "qualified" timelock technician is a recognized locksmith professional who has been trained in the area of mechanical timelocks in a recognized facility and can provide reasonable proof thereof.
 - b. The final determination of the cause of the lockout will be with the manufacturer based on a written report submitted by the qualified timelock technician and an examination of the returned mechanical timelock.
 - c. Upon valid verification of the mechanical timelock's failure, Relhdis will reimburse a mutually agreed upon "not to exceed" sum to the safe or vault manufacturer — not the safe technician or the end-user. This sum shall be within the limits of the current "reasonable" pricing structure of the safe and vault industry for similar openings and repairs.
 - d. This conditional guarantee covers only the operation of the mechanical timelock and reimburses only charges described in "c" above. This guarantee is intended to be effective only in the event that the Relhdis mechanical timelock fails in the field and requires a "forced" opening.
2. The twenty-four (24 months) warranty against factory defects in manufacturing covers the replacement of the Relhdis mechanical timelock. It is a direct one-to-one replacement program in which the defective mechanical timelock is exchanged for a new mechanical timelock with Relhdis paying the freight both ways.
 - a. This warranty does not cover any misuse in the installation, day-to-day operation, or servicing of the mechanical timelock.
 - b. Relhdis mechanical timelocks are to be free of defects in material and workmanship for a period of two years (24 months). This two-year period begins with the shipment from seller's point of manufacture.
 - c. This program is subject to revision without notice. Please contact your Relhdis Lock Sales representative for the current status.

Three Movement Time Lock Installation, Operation, and Maintenance

1600 SERIES



RELHDIS SA

Rte de Neuchâtel 15a
CH 2072 SAINT-BLAISE / SWITZERLAND

Tel.: +41 32 756 10 40

Fax: +41 32 756 10 49

E-mail : mail@relhdis.com

Installation

Tools Required

- Small Phillips screwdriver
- 3/8" (9 mm) Allen wrench
- 5/32" (4 mm) Allen wrench

Install the Time Lock

1. Remove the four screws securing the cover to the case using a small Phillips screwdriver. Lift off the cover.
2. Remove the two socket screws located on either side of the lever mount using a 5/32" (4 mm) Allen wrench. Lift the mounting plate with the attached movements off the time lock case.
3. Insert the four mounting screws through the four holes in the back of the time lock case.
4. Add a rubber washer onto each screw between the time lock case and the safe or vault door mounting plate.
5. Tighten the screws using a 3/8" (9 mm) Allen wrench until the washers are compressed approximately 1/8" (3 mm).
6. Re-attach the mounting plate with the attached movements using the two socket screws, ensuring that the locking lever engages under the snubber block actuating pin.
7. Replace the cover using the four screws.
8. Test the operation of the lock several times: Set the movements for a short time period. Activate the snubber block by pressing down the locking lever to the Lock position. Then, move the manual release pin to the right to deactivate the snubber block.

Operation

Set the Time Lock

1. Determine the number of hours the 64 Series must remain locked.
2. Insert the winding key through the eyelet opposite each movement.
3. Turn the key in a counterclockwise direction until the desired number of locking hours is directly under the pointer. Repeat for the second and third movements.
4. Once all the movements are wound, verify that the movements are running.

Important: Never lock the door unless at least two movements are running.

5. Activate the snubber block by pressing down the locking lever to the Lock position.

Day Open Feature—Once the movements are wound, the time lock can be left in the Open position, permitting the safe or vault to remain unlocked during business hours. To relock the safe or vault, activate the snubber block by pressing down the locking lever to the Lock position.

Release Feature—The time lock can be manually changed from the Lock to the Open position. To unlock the safe or vault, activate the snubber block by moving the manual release pin to the right. The door can then be opened without unwinding or releasing time on the movements.

Maintenance

Relhdis recommends that the following procedures be performed annually.

Important: Only a trained technician or local watchmaker should perform movement maintenance (cleaning and calibrating).

Tools Required

- Large slotted screwdriver
- Non-linting shop cloth
- Miniature slotted screwdriver
- Small Phillips screwdriver
- 5/32" (4 mm) Allen wrench
- Soft-bristle brush

Remove the Mounting plate and Replace the Movements

1. Remove the four screws securing the cover to the case using a small Phillips screwdriver. Lift off the cover.
2. Remove the two brass slotted screws located on either side of the carrier using a large slotted screwdriver. Remove the carrier and locking lever.
3. Remove the two socket screws located on either side of the lever mount using a 5/32" (4 mm) Allen wrench. Lift the mounting plate off the time lock case.
4. Remove the three slotted screws securing each movement to the mounting plate using a miniature slotted screwdriver.
5. Remove each movement, handling them by the winding stem only.
6. Replace the old movements with new movements (temporary or permanent). Secure each movement with three slotted screws.

Clean the Time-Lock Case

1. From the time-lock case, remove the two brass slotted screws that secure the snubber block in its track using a large slotted screwdriver.
2. Remove the snubber block.
3. Remove dust from the interior of the case and the snubber block using a hand bellows or soft-bristle brush. Inspect all components for signs of damage or excessive wear.

Note: Lubrication is NOT recommended.

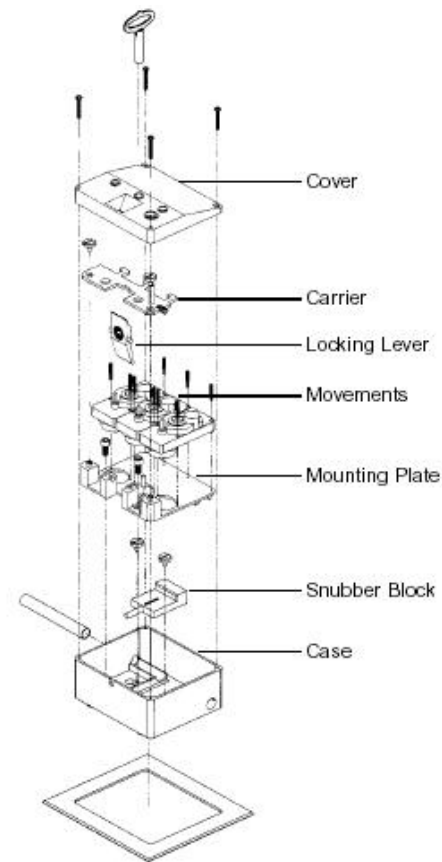

Re-assemble the Time Lock

1. Replace the snubber block and the two brass slotted screws.
2. Re-attach the mounting plate to the time-lock case using the two socket screws.
3. Replace the lever, ensuring that it is under the snubber block shaft.
4. Replace the carrier with caution while applying pressure to the spring against the case wall. Ensure that the pins on the dial faces are clear of the carrier. Install the two brass slotted screws to secure the carrier.
5. Adjust the coordination of the movements with the release mechanism so that they are synchronized. To modify the pressure required to

- release the carrier, adjust the cam post (the pin through the lever) from the bottom of the case using a miniature slotted screwdriver.
6. Clean any areas handled when reattaching the mounting plate to the case.
 7. Dust and clean the cover on both sides. Replace the cover using the four screws.
 - 8.

Notes on the Relhor Movements

Movements with an accelerator (snap action) do not require calibration. They unlock as follows:

Once the "0 hour" position is reached, a separate gearing system accelerates the rotation of the dial. The carrier is engaged, releasing the bolt blocking arm.

Movements without the accelerator feature may be calibrated as follows: Set time on the movements so that only one movement at a time will release the bolt blocking arm. To this, wind more time on the movement that is not being calibrated. When the movement that is being calibrated releases the blocking arm, loosen the retaining screw in the center of the movement dial and rotate it so that it aligns with "0". Repeat this procedure for the second movement if necessary.

Standard movements (those without a reset option), if mistakenly set for a period of time longer than desired, cannot be reset by rotating the key clockwise. Doing so may result in damage to the movement.

